



icmr
INDIAN COUNCIL OF
MEDICAL RESEARCH
Serving the nation since 1911

NIV
NATIONAL INSTITUTE
OF VIROLOGY

आई सी एम आर - राष्ट्रीय विषाणु विज्ञान संस्थान

स्वास्थ्य अनुसंधान विभाग
स्वास्थ्य एवं परिवार कल्याण मंत्रालय, भारत सरकार

ICMR - NATIONAL INSTITUTE OF VIROLOGY

Department of Health Research
Ministry of Health & Family Welfare, Govt. of India

PP no. 1564/NIV-Purchase/2023-24

Dt. 29 July, 2023

QUOTATION ENQUIRY

Sealed quotations are invited on behalf of the Director, ICMR-National Institute of Virology, Pune for "Portable Cabin". Interested vendors should submit their quotation along with their company/personal profile and details given below:

Sl. No	Item Name	Qty. Required	Remarks
1	Portable Cabin G+1 (Including Ms Bed + Mattress & Storage Cabinets)	2	Specifications & Drawing copy attached. (To be installed at - ICMR NIV, MCC 130/1, Sus Road, Pashan, Pune -411021).
2	Portable Cabin Ground floor (Including Ms Bed + Mattress & Storage Cabinets)	1	Specifications & Drawing copy attached. (To be installed at - ICMR NIV, MCC 130/1, Sus Road, Pashan, Pune -411021).

The quotation super scribed as "Portable Cabin" addressed to the Director, ICMR-National Institute of Virology, 20-A, Dr. Ambedkar Road, P.B. No.11, PUNE -411 001. (Attention: Administrative officer - Stores), should be either dropped at the Stores Department at NIV Pune or sent through Speed Post/Courier latest by 23rd Aug, 2023 till 5.00 p.m.

OTHER TERMS & CONDITIONS

1. This is an enquiry and must not be treated as an order.
2. The NIV, Pune office reserves the right to accept or reject any or all applicants without assigning any reasons.
3. Any decision taken by the Director, NIV Pune at any point of time in connection with this process shall be final and conclusive and no claim or dispute from any quarter in that regard shall be entertained.
4. No advance payment will be made. The payment will be made on receipt of services availed and satisfactory report of the end users.
5. NIV, Pune will not be responsible for any delay for receipt of quotations.
6. Requirement of Portable Cabin will either increase or decrease final requirement will be mentioned in the P.O order issued to the firm.

A. Sakare
29/7
Administrative Officer

Specification for Basic Portable Cabins

Sr. No	COMPONENTS	DESCRIPTION
1	Bottom Frame	100x50 mm ISMB/ISMC/ For Toilet & Security 80x40 mm MS Sq. pipe
2	Top Frame	50mm x 50mm MS Sq. Pipe
3	Stiffener Bottom	80mm x 40mm MS Sq Pipe or 100x50 mm ISMC
4	Stiffener Top	40 x 20 M.S. Sq. Pipe
5	Side Post	65mm x 65mm MS Sq. Pipe
6	Paneling Outside	1 mm GI Corrugated Sheet (Jindal/AMNS)
7	Internal Wall Paneling	8 mm MDF Board / For Toilet 4 mm ACP Sheet
8	Roof Outside	G.I. 1mm SHEET (make Jindal/Essar/ Uttam) Properly welded for Strength up to and water tight with TARFELT Sheet.
9	False Ceiling	8mm MDF Board
10	Bottom Flooring	18mm Cement Board with Vinyl Carpet
11	Aluminum Windows	Aluminum Powder Coated Windows /For Toilet NA
12	Door	All Doors will be Insulated with for locking agreement, Hold draft & Handles.
13	Insulation	Proper Glass Wool Insulation 25 mm(16kg/m3) / For Toilet NA
14	Wiring	All wiring shall be concealed type & shall be of PVC insulated copper wire. (Polycab/Finolex)
15	Electrical Fittings	All electrical fittings in the Portable Cabin shall be 220-240 V, AC 50Hz LED, Door Light, Fan, Switches, Sockets, Point (MCB).
16	Ear thing	Earthing Point shall be provided for SAFETY
17	Outside Painting	Phosphate the Cabin and painting with 1coat of Epoxy primer with Two Coat of Epoxy Paint.
18	Legs	6-inch height, Four legs at all four corners
19	Hooks	Specially formed Hooks for Easy lifting and shifting
20	Furniture	18 mm Particle Board
21	MS Platform & Railing	Frame - 50x50 & 40x20 mm MS Sq. Pipe Railing - 40x20 mm MS Pipe

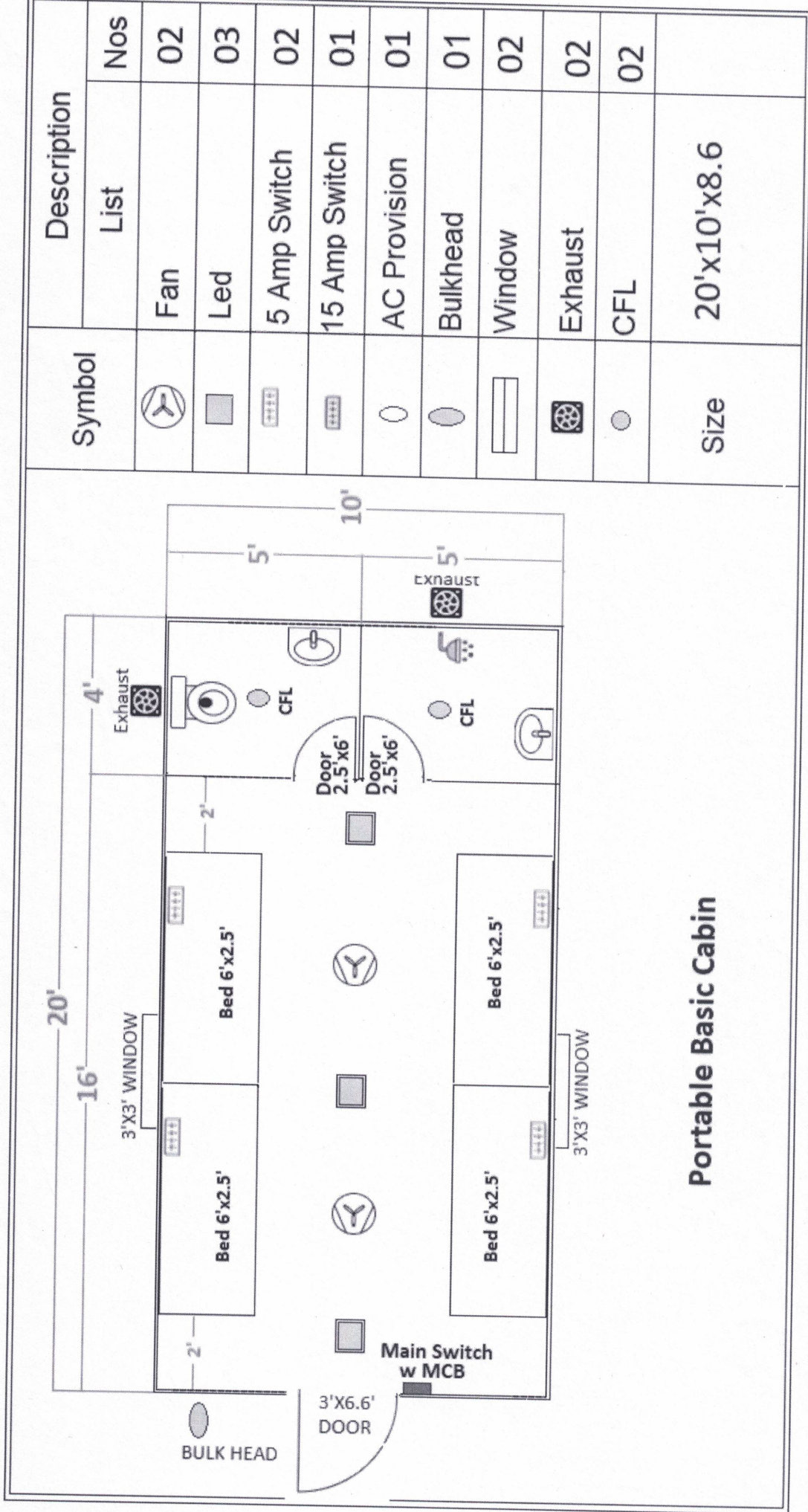

Portable Basic Cabin

Symbol	Description	
	List	Nos
	Fan	02
	Led	03
	5 Amp Switch	02
	15 Amp Switch	01
	AC Provision	01
	Bulkhead	01
	Window	02
	Exhaust	02
	CFL	02
	Size	20'x10'x8.6